

Notes
 Check all dimensions on site. Do not scale from this drawing
 Report any discrepancies and omissions to HLM Architects
 This Drawing is Copyright ©

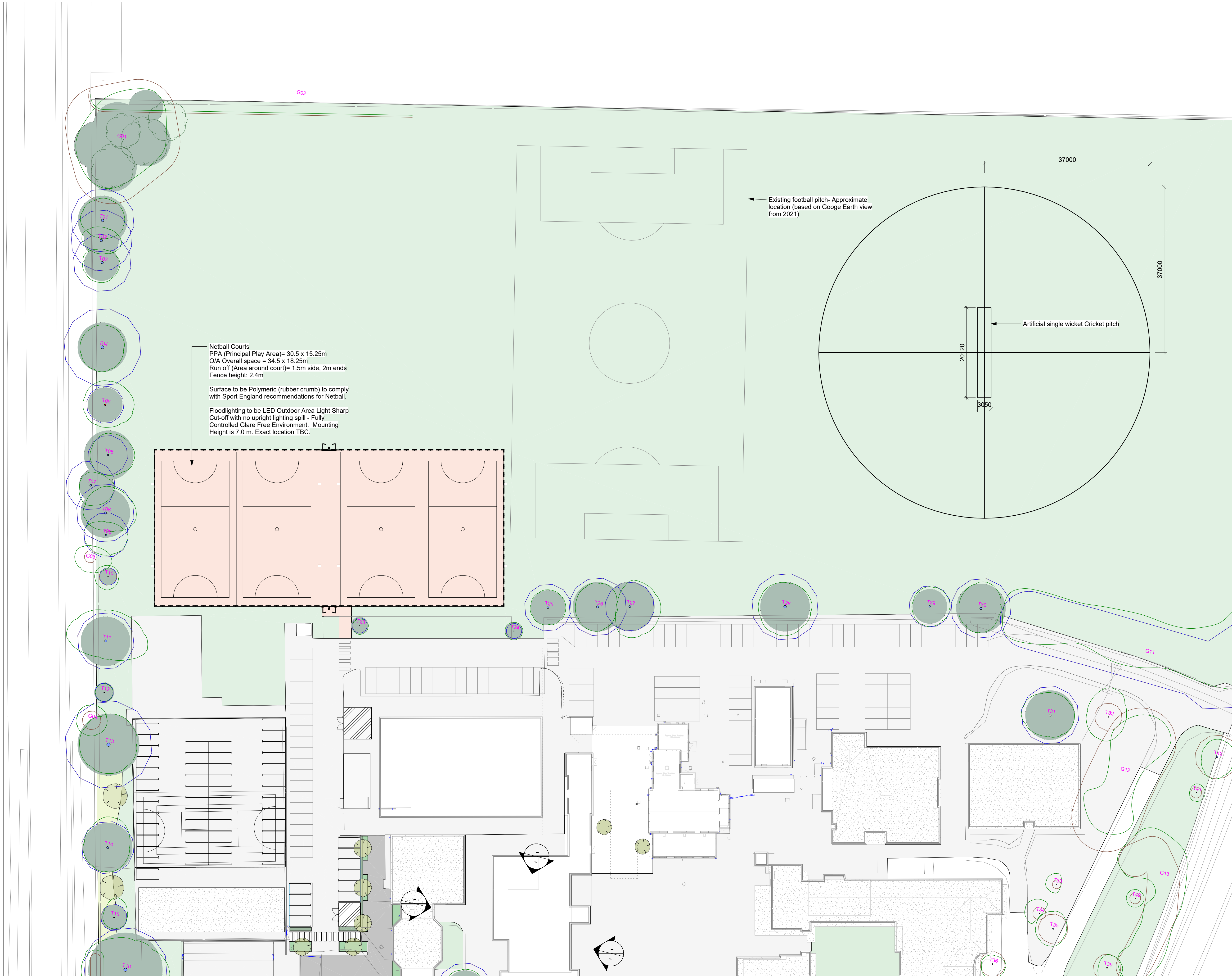

Netball Courts
 PPA (Principal Play Area)= 30.5 x 15.25m
 OJA Overall space = 34.5 x 18.25m
 Run off (Area around court)= 1.5m side, 2m ends
 Fence height: 2.4m

Surface to be Polymeric (rubber crumb) to comply with Sport England recommendations for Netball.

Floodlighting to be LED Outdoor Area Light Sharp
 Cut-off with no upright lighting spill - Fully
 Controlled Glare Free Environment. Mounting
 Height is 7.0 m. Exact location TBC.

Existing football pitch- Approximate location (based on Google Earth view from 2021)

Artificial single wicket Cricket pitch

83

Rev	Description	Date	By	Chk	Suitability
P01	ISSUED FOR PLANNING INFORMATION	08/03/23	NK	HLM	

Project S3 REVIEW AND COMMENT

Piggott School Landscape

Client
Wokingham Borough Council

NETBALL COURTS & CRICKET PITCH LAYOUT

Drawing No.	Revision
PGT-HLM-ZZ-00-DR-L-15009	P01

Scale	Drawn
1 : 400 @A1	NK
Date	Checked
08/03/23	HLM



© HLM Architects
 2nd Floor
 The Ruskin Building
 Tudor Square
 Sheffield S1 2LA

www.hlmarchitects.com
 T. +44 (0) 114 263 9600
 F. +44 (0) 114 263 9650
 sheffield@hlmarchitects.com



This page is intentionally left blank